

BT-Doppio

Instructions for Graphic Installation

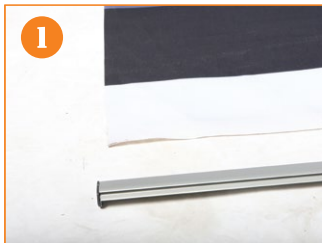

1. Arrange the graphic and the top bar so they are parallel to each other.



2. Remove the end caps on both sides.



3. Open the top bar.



4. Insert the graphic into the top bar and press to close.



5. Insert the end caps on both sides.



6. Arrange the graphic and the base leader parallel to each other.



7. Peel off the adhesive paper.



8. Attach the base of the graphic on top of the adhesive and press firmly to secure.



9. Hold the graphic and remove the spring key.



10. Slowly retract the graphic into the base.



BT-Doppio

Instructions for Display Unit



1. Doppio double-sided banner stand consist of 2 Cubes and a set of cube connectors.



2. Take out the poles from the base. Place the Cubes on the ground parallel to each other with feet facing up.



3. Connect the cubes by placing the connectors on each sides of the hardware.



4. Turn the knobs to locked position to secure the unit.



5. Completed Doppio base



6. Option: Turn the feet about 60 degree sideways to add additional stablization to the base.



7. Connect two of the 3 section poles.



8. Insert the poles into each base.



9. Using the arch profile connector, attach the top clamp on both sides.



10. Attach the top bars on the top clamp profile and complete the Doppio double-sided banner stand.

